

## CONFERENCE ARRANGEMENTS

### Rates per person and per day

Combining traditional charm with modern services, we make sure that your conferences are as enjoyable, effective and productive as possible

### DAILY ARRANGEMENT

- > Plenary room including mineral water for all participants (2 x 50 cl per guest)
- > Flip chart, overhead projector, screen, telephone, beamer Notebooks, pencils and mints
- > Two coffee breaks per day with coffee, orange juice, soft drinks and an assortment of danish pastries in the morning, cookies or cakes in the afternoon
- > Lunch consisting of a 3-course set meal or one of our buffets for conference delegates, coffee included (beverage not included)
- > Printed menu (1 per guest)

**Chf. 140.- per person & per day**

### HALF DAY ARRANGEMENT

- > Plenary room with mineral water for the participants (1 x 50 cl per guest)
- > Flip chart, overhead projector, screen, telephone, beamer Notebooks, pencils and mints
- > One coffee break per day with coffee, orange juice, soft drinks and an assortment of danish pastries in the morning, cookies or cakes in the afternoon
- > Lunch consisting of a 3-course set meal or one of our buffets for conference delegates, coffee included
- > Printed menu (1 per guest)

**Chf. 110.- per person & per day**

## OUR TECHNICAL EQUIPMENT

### Rates per day

For your conference or seminar the Lausanne Palace & Spa offers a particularly varied choice of high-technology equipment

### BASIC EQUIPMENT

Digital telephone - Conference tables and chairs - Notepads - Pencils and blotters - Mints - Lecturing desk (without microphone) - Grey carpeted stage

### SOUND EQUIPMENT

- > Wireless microphone Chf 110.-
- > Tie microphone Chf 110.-
- > Sound system Chf 150.-
- > Lecturing desk with microphone installation Chf 120.-

In case your event hosts more than 45 participants, our banqueting and conference department will be pleased to send you a personalised offer.

### PROJECTION EQUIPMENT

- > Overhead projector with marker pens Chf 75.-
- > Screen Chf 120.-
- > Beamer Chf 380.-
- > Flat screen LCD 16/9 Chf 380.-
- > VHS Videorecorder - DVD/CD Monitor Chf 110.-

### SECRETARIAL WORK

- > Secretarial work per half-hour Chf 35.-
- > Per hour Chf 45.-
- > Photocopies up to 100 copies - per copy Chf 0.50
- > Photocopies more than 100 copies - per copy Chf 0.30
- > Colour photocopies - per copy Chf 2.-
- > Copy of transparencies - per copy Chf 1.-
- > Wrapper (500 sheets of paper) Chf 15.-
- > PC or Mac computer with printer Price on demand

### MISCELLANEOUS EQUIPMENT

- > Flag and flag-holder Chf 15.-
- > Laser pointer Chf 25.-
- > Flip-chart, paper and marker pens Chf 25.-
- > CD player Chf 65.-
- > Multi-format DVD player Chf 75.-
- > Clockroom watched Chf 2.-/pers

### PRICES UPON REQUEST

Barco 8100/9200 projector - Barco retrographics 801/808 projector - Data LCD Monitor PC desktop Pentium computer - Pentium notebook - Laser printer Sony/Panasonic video camera - Sony/Panasonic video mixing desk - Simultaneous translation

## BUSINESS MEETINGS



## OUR CONFERENCE ROOMS

Our conference rooms offer space and capacity that can be adapted to suit different needs. In a unique setting, they are especially designed to optimise the comfort

	ALPHA	BETA	GAMMA	DELTA	EPSILON	SIGMA	OMEGA	IOTA	ALPHA & BETA	BETA & GAMMA	ALPHA & BETA & GAMMA	DELTA & EPSILON	IOTA & OMEGA	IOTA & OMEGA & SIGMA	SIGMA & EPSILON & DELTA
<b>Dimension in meters</b>															
Length	6.20	5.80	7.90	4.30	4.80	6.30	4.80	3.90	12.00	13.70	19.90	9.10	8.70	15.00	15.40
Width	6.30	6.30	6.30	5.20	5.20	5.20	5.20	5.20	6.30	6.30	6.30	5.20	5.20	5.20	5.20
Height	2.45	2.45	2.45	2.45	2.45	2.45	2.45	2.45	2.45	2.45	2.45	2.45	2.45	2.45	2.45
<b>Surface area</b>															
Surface area in sq.m	40	37	50	23	23	34	23	22	75	86	125	47	45	78	80
<b>Capacities</b>															
School style	18	-	18	-	-	-	-	-	25	30	50	-	14	28	28
Theater style	30	18	35	-	-	-	-	-	48	58	80	32	32	65	65
U-Shape	14	14	16	-	-	-	-	-	24	30	44	-	-	-	-
Boardroom style	12	10	16	6	6	8	6	6	22	22	40	16	17	28	16
<b>Rates in Chf.</b>															
Half-day	400	400	400	200	200	300	200	200	600	600	800	400	400	450	450
Day	500	500	500	300	300	400	300	300	800	800	1'000	500	500	600	600
Exhibition	650	650	650	400	400	500	400	400	1'000	1'000	1'500	650	650	800	800

A member of  
**The Leading Hotels of the World®**

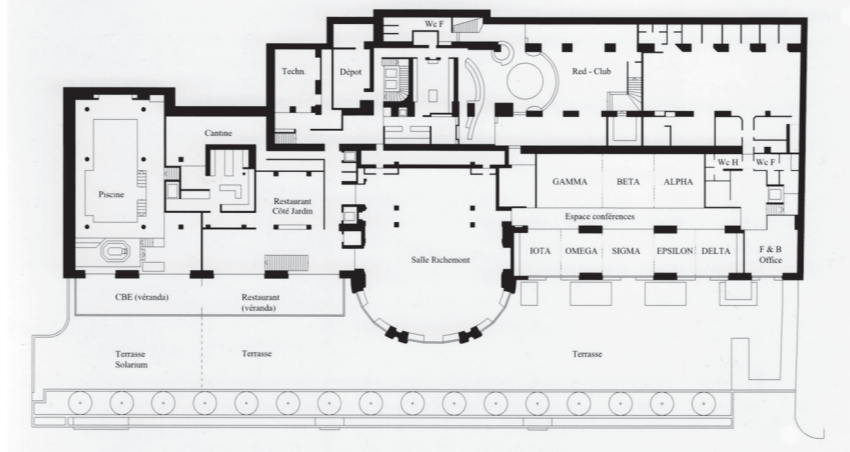
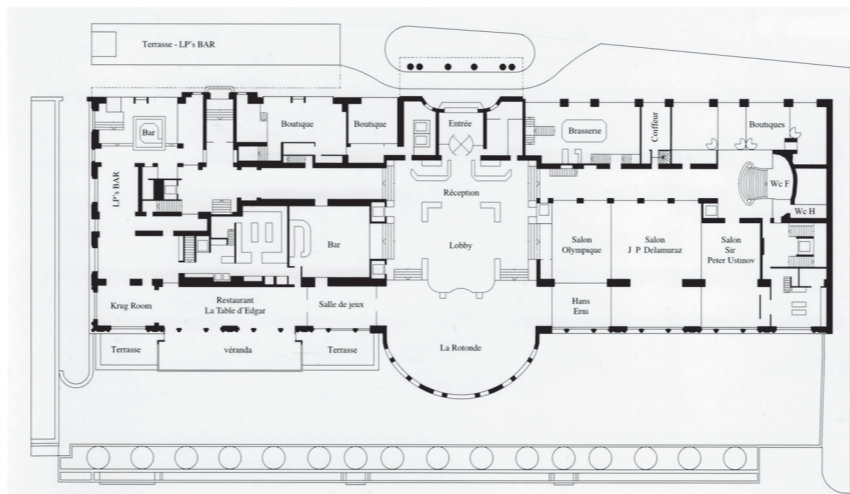

GRAND-CHÊNE 7-9 > 1002 LAUSANNE > T. +41 21 331 31 31  
MANIFESTATIONS@LAUSANNE-PALACE.CH > WWW.LAUSANNE-PALACE.COM

## OUR PRIVATE SALONS

Our "private" rooms offer space and capacity that can be adapted to suit different needs. They are especially designed to optimise your comfort.

	Salon Olympique	Salon Jean-Pascal Delamaraz	Salon Sir Peter Ustinov	Salon Hans Erni	Salon Olympique + Salon Jean-Pascal Delamaraz	Salon Olympique + J. P. Delamaraz + Sir P. Ustinov	Salle Richemont
--	-----------------	-----------------------------	-------------------------	-----------------	---	--	-----------------

### Dimension in meters

Length	14.85	14.85	12.75	4.80	14.85	14.85	21.45
Width	7.15	10.80	7.20	7.90	16.90	23.40	16.60
Height	4.80	4.80	4.80	4.80	4.80	4.80	4.80

### Surface area

Surface area in sq.m	106	131	92	32	236	330	250
----------------------	-----	-----	----	----	-----	-----	-----

### Capacities

Banquet style	60	100	50	8	150	300	200
Cocktail style	80	130	70	10	300	400	350
School style	30	70	30	-	100	130	120
Theater style	60	120	50	-	170	200	200
U-Shape	25	35	20	-	50	60	50
Boardroom style	25	30	25	8	55	70	50

### Rates in Chf.

Half-day	450.-	600.-	450.-	300.-	1'050.-	1'450.-	1'100.-
Day	600.-	800.-	600.-	400.-	1'400.-	1'900.-	1'500.-
Exhibition	750.-	1'000.-	750.-	-	2'200.-	2'800.-	2'300.-



Swiss Deluxe Hotels