

Luxury in the shadow of splendor
Le luxe dans l'ombre de la splendeur
Luxus im Schatten von Eleganz und Schönheit

Fairmont
LE MONTREUX PALACE
MONTREUX, SWITZERLAND

EVENTS GUIDE | GUIDE ÉVÉNEMENTIEL | VERANSTALTUNGSFÜHRER







AU MILIEU DES MONTAGNES ENNEIGÉES ET DES EAUX SCINTILLANTES DU LÉMAN
INMITTEN SCHNEEBEBECKTER BERGE UND SPRUDELNDEN GEWÄSSERN





Welcome to Fairmont Le Montreux Palace

The ideal place to organize your conferences, exhibitions, product launches, banquets, workshops and incentives, from 5 to 900 people. Every detail will meet your expectations, because fulfilling your needs is our mission.

Bienvenue au Fairmont Le Montreux Palace

Lieu idéal pour organiser vos conférences, expositions, lancements de produits, banquets, workshops et incentives... de 5 à 900 personnes. Chaque détail a pour nous une grande importance. Notre principale préoccupation ? Faire de votre manifestation un succès.

Herzlich willkommen im Fairmont Le Montreux Palace

Der ideale Ort für Ihre Konferenzen, Ausstellungen, Produktpräsentationen, Bankette, Workshops und Incentives... für 5 bis 900 Personen. Wir kümmern uns um jedes kleinste Detail, denn unser Ziel ist es, Ihre Erwartungen zu übertreffen.



HOSPITALITY

Fairmont Le Montreux Palace offers a traditional and elegant atmosphere, in which each guest can experience personalized service and attention to detail in the true Swiss tradition.

L'ACCUEIL D'UN PALACE

Fairmont Le Montreux Palace offre une atmosphère mêlée de tradition et d'élégance où chaque hôte jouit d'une attention particulière et d'un service personnalisé, dans le pur respect de la tradition suisse.

DER EMPFANG IN EINEM PALACE

Fairmont Le Montreux Palace verwöhnt seine Gäste mit besonderer Aufmerksamkeit und persönlichem Service und bietet eine gelungene Mischung aus Tradition und Eleganz.







LOBBY

The lobby, with its magnificent spaces, is the ideal setting for cocktail receptions and buffets.

HALL

*Le hall, un espace féérique...
Emplacement idéal pour
accueillir vos cocktails, réceptions
et buffets.*

LOBBY

Die Lobby, ein traumhafter Ort... Ideal für Ihre Cocktails, Empfänge und Buffets.





ROOMS

Our 236 guest rooms and suites are elegantly appointed and luxuriously furnished, offering both traditional comfort and the latest technology.

CHAMBRES

Les 236 chambres et suites marient élégance, décoration raffinée, confort et technique moderne afin de vivre un séjour des plus exquis.

ZIMMER

Die 236 Zimmer und Suiten verbinden Eleganz, raffinierte Dekoration, Komfort und modernste Technik.



Salle des Congrès

DIMENSIONS

| | |
|----------|--------------------|
| Area | 374 m ² |
| Length | 32.5 m |
| Width | 11.5 m |
| Height | 5–9 m |
| Daylight | YES |
| Blackout | NO |

CAPACITIES

| | |
|-----------|-----|
| Theater | 350 |
| Classroom | 240 |
| Cocktail | 600 |
| Banquet | 340 |
| Buffet | 260 |

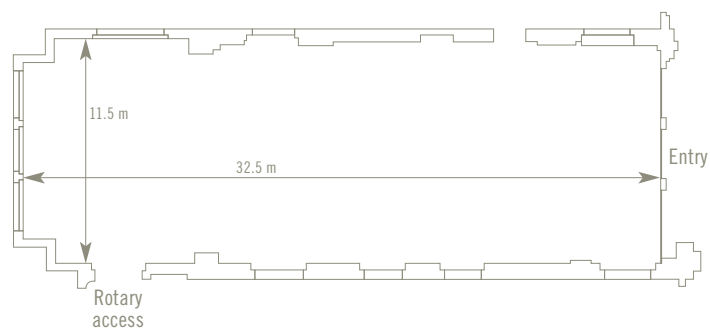



Salon Rotary

DIMENSIONS

| | |
|----------|-------------------|
| Area | 98 m ² |
| Length | 11.5 m |
| Width | 8.5 m |
| Height | 8 m |
| Daylight | YES |
| Blackout | YES |

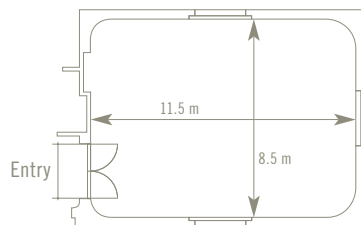

CAPACITIES

| | |
|-----------|----|
| Theater | 80 |
| Classroom | 50 |
| Cocktail | 90 |
| Banquet | 60 |
| Buffet | 40 |
| U-shape | 30 |
| Boardroom | 28 |





Salle des Fêtes

DIMENSIONS

| | |
|----------|--------------------|
| Area | 231 m ² |
| Length | 21 m |
| Width | 11 m |
| Height | 5–9 m |
| Daylight | PARTIAL |
| Blackout | PARTIAL |

CAPACITIES

| | |
|-----------|-----|
| Theater | 210 |
| Classroom | 120 |
| Cocktail | 400 |
| Banquet | 180 |
| Buffet | 120 |
| U-shape | 60 |
| Boardroom | 50 |

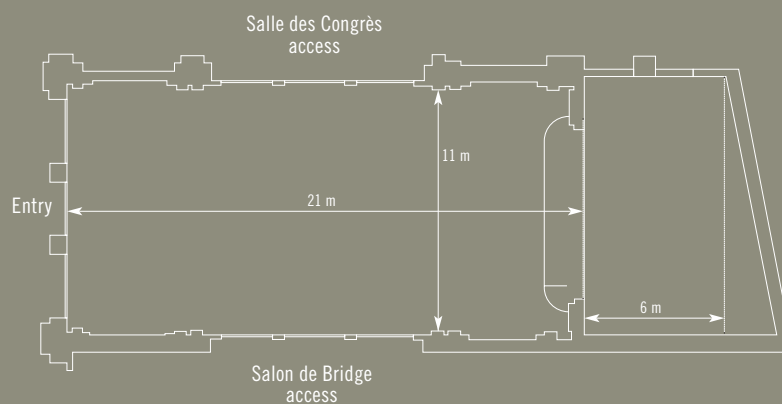

Salon de Bridge

DIMENSIONS

| | |
|----------|--------------------|
| Area | 132 m ² |
| Length | 22 m |
| Width | 6 m |
| Height | 3–6 m |
| Daylight | YES |
| Blackout | PARTIAL |

CAPACITIES

| | |
|-----------|-----|
| Theater | 120 |
| Classroom | 60 |
| Cocktail | 120 |
| Banquet | 90 |
| Buffet | 60 |
| U-shape | 50 |
| Boardroom | 50 |

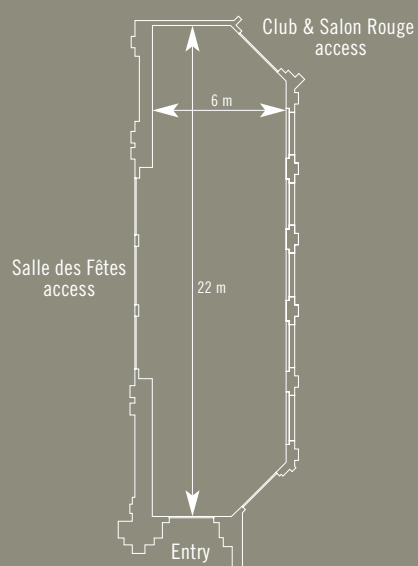



Salon Club

DIMENSIONS

| | |
|----------|-------------------|
| Area | 95 m ² |
| Length | 10.6 m |
| Width | 9 m |
| Height | 3.5–6 m |
| Daylight | YES |
| Blackout | YES |

CAPACITIES

| | |
|-----------|----|
| Theater | 70 |
| Classroom | 50 |
| Cocktail | 80 |
| Banquet | 60 |
| Buffet | 40 |
| U-shape | 26 |
| Boardroom | 22 |

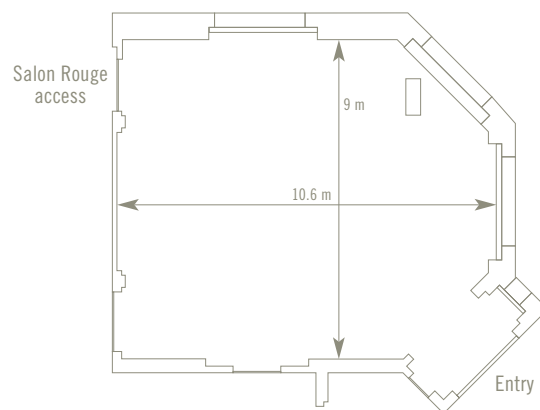



Salon Rouge

DIMENSIONS

| | |
|----------|-------------------|
| Area | 60 m ² |
| Length | 10 m |
| Width | 6 m |
| Height | 6 m |
| Daylight | YES |
| Blackout | NO |

CAPACITIES

| | |
|-----------|----|
| Theater | 20 |
| Classroom | 10 |
| Boardroom | 15 |





Salon Vert

DIMENSIONS

| | |
|----------|-------------------|
| Area | 60 m ² |
| Length | 10 m |
| Width | 6 m |
| Height | 2.5-4 m |
| Daylight | YES |
| Blackout | NO |

CAPACITIES

| | |
|-----------|----|
| Banquet | 18 |
| Boardroom | 18 |

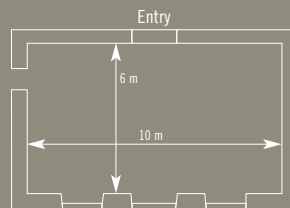

Pléiades

DIMENSIONS

| | |
|----------|-------------------|
| Area | 44 m ² |
| Length | 7.7 m |
| Width | 5.7 m |
| Height | 3 m |
| Daylight | YES |
| Blackout | YES |

CAPACITIES

| | |
|-----------|----|
| Theater | 40 |
| Classroom | 24 |
| Cocktail | 40 |
| Banquet | 20 |
| U-shape | 17 |
| Boardroom | 16 |

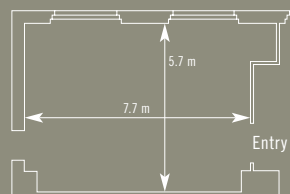

Rochers-de-Naye

DIMENSIONS

| | |
|----------|-------------------|
| Area | 73 m ² |
| Length | 8.45 m |
| Width | 8.6 m |
| Height | 2.65 m |
| Daylight | YES |
| Blackout | YES |

CAPACITIES

| | |
|-----------|----|
| Theater | 48 |
| Classroom | 24 |
| Cocktail | 40 |
| Banquet | 30 |
| U-shape | 20 |
| Boardroom | 18 |

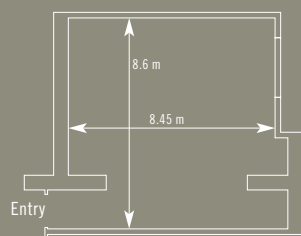

Dents-du-Midi

DIMENSIONS

| | |
|----------|-------------------|
| Area | 60 m ² |
| Length | 9.7 m |
| Width | 6.2 m |
| Height | 2.52 m |
| Daylight | NO |
| Blackout | YES |

CAPACITIES

| | |
|-----------|----|
| Theater | 60 |
| Classroom | 35 |
| Cocktail | 40 |
| Banquet | 40 |
| U-shape | 24 |
| Boardroom | 22 |

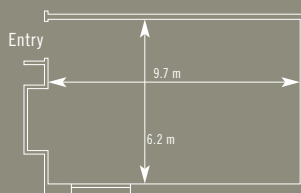



Léman A–B and Léman C

LÉMAN A

DIMENSIONS

| | |
|----------|--------------------|
| Area | 532 m ² |
| Length | 28 m |
| Width | 19 m |
| Height | 5.65 m |
| Daylight | YES |
| Blackout | YES |

CAPACITIES

| | |
|-----------|-----|
| Theater | 530 |
| Classroom | 320 |
| Cocktail | 800 |
| Banquet | 450 |
| Buffet | 370 |

LÉMAN B

DIMENSIONS

| | |
|----------|--------------------|
| Area | 266 m ² |
| Length | 14 m |
| Width | 19 m |
| Height | 5.65 m |
| Daylight | YES |
| Blackout | YES |

CAPACITIES

| | |
|-----------|-----|
| Theater | 250 |
| Classroom | 170 |
| Cocktail | 400 |
| Banquet | 210 |
| Buffet | 160 |

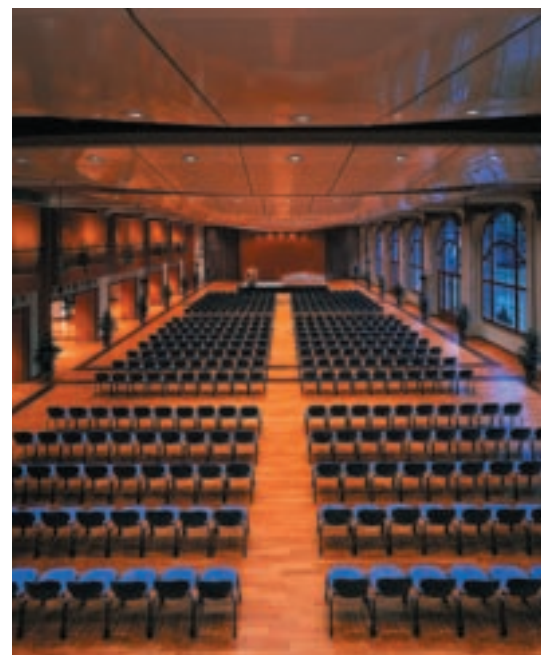



LÉMAN A+B

DIMENSIONS

| | |
|----------|--------------------|
| Area | 798 m ² |
| Length | 42 m |
| Width | 19 m |
| Height | 5.65 m |
| Daylight | YES |
| Blackout | YES |

CAPACITIES

| | |
|-----------|------|
| Theater | 900 |
| Classroom | 550 |
| Cocktail | 1200 |
| Banquet | 690 |
| Buffet | 520 |

LÉMAN C

DIMENSIONS

| | |
|----------|--------------------|
| Area | 286 m ² |
| Length | 22 m |
| Width | 13 m |
| Height | 2.55–5.65 m |
| Blackout | NO |

CAPACITIES

| | |
|----------|-----|
| Cocktail | 250 |
|----------|-----|

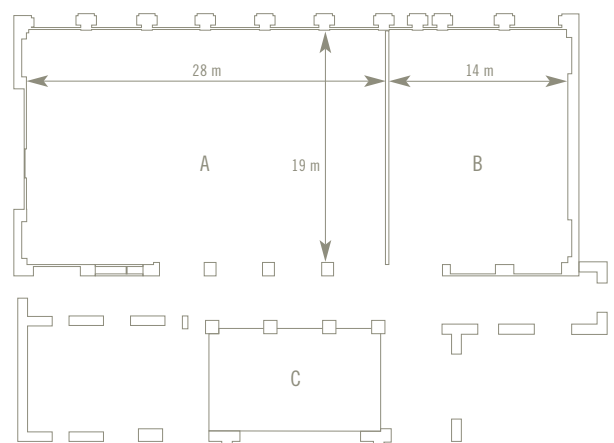

La Terrasse du Petit Palais and La Coupole

TERRASSE

DIMENSIONS

Length 13.5 m

Width 43.7 m

CAPACITIES

Cocktail 800

Banquet 400

COUPOLE

DIMENSIONS

Length 19 m

Width 12.6 m

CAPACITIES

Cocktail 300

Banquet 130

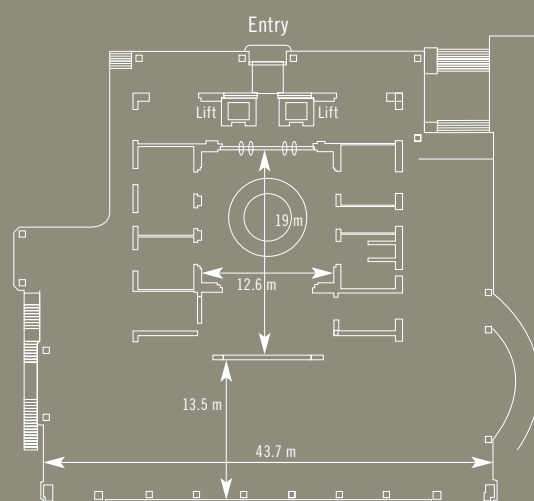







RESTAURANTS AND BARS

Choices to suit any taste: La Brasserie du Palace will delight you with traditional ambience, and Harry's New York Bar serves up jazzy melodies with sophisticated fare.

RESTAURANTS ET BARS

A l'heure du repas à vous de choisir ! La Brasserie du Palace vous régale d'une cuisine gourmande ou le Harry's New York Bar vous réserve un dîner rythmé par des mélodies jazzies.

RESTAURANTS UND BARS

Sie haben die Wahl! Die Brasserie du Palace bietet Gerichte für Feinschmecker und die Harry's New York Bar verzaubert bei einem Abendessen mit Jazzklängen.



WILLOW STREAM SPA

Step into an oasis of water, wood and stone, where your body, mind and soul are gently nurtured by pampering hands and soothing elements of nature. Find your energy at Willow Stream Spa.

WILLOW STREAM SPA

Plongez dans une oasis d'eau, de bois, et de pierre où le corps, l'esprit et l'âme sont choyés avec une infinie douceur au sein d'une nature apaisante. Bienvenue au Willow Stream Spa.

WILLOW STREAM SPA

Treten Sie ein in eine Oase aus Wasser, Holz und Stein, in der Ihre Ressourcen für Körper, Geist und Seele durch verwöhnende Behandlungen und schmeichelnde Natur aufgefüllt werden. Willkommen in der Welt von Willow Stream Spa.





DESTINATION ACTIVITIES

Summer or winter, Fairmont Le Montreux Palace will take care of you from A to Z—at your arrival by organizing your transfers, and during your visit, by creating memories that will last a lifetime: a medieval evening, a dinner cruise on Lake Geneva, a helicopter ride or mountain activities... anything is possible.

ACTIVITÉS DANS LA RÉGION

Été comme hiver, Fairmont Le Montreux Palace vous prend en charge de A à Z—dès votre arrivée en organisant vos transferts, puis lors de votre séjour en imaginant pour vous un séjour de rêve : une soirée médiévale, un dîner sur le lac, une balade en hélicoptère ou des activités en montagne... tout est possible.

ACTIVITÄTEN IN DER UMGEBUNG

Im Sommer wie im Winter — das Fairmont Le Montreux Palace kümmert sich um Ihre Wünsche von A bis Z. Wir organisieren Ihre Transfers zum Hotel und sorgen dafür, dass Ihr Aufenthalt zu etwas ganz Besonderem wird: ein Abendessen in einem Schloss, ein Dinner auf dem Genfer See, der Ausflug mit dem Hubschrauber, Aktivitäten in den Bergen... Alles ist möglich.





CAPACITIES OF OUR CONFERENCE & BANQUET ROOMS

FAIRMONT LE MONTREUX PALACE SITE MAP

CAPACITIES

| ROOM NAME | PAGE NO. | THEATER | | CLASSROOM | | COCKTAIL | BANQUET | | BUFFET | | U-SHAPE | BOARDROOM |
|-----------------------------|----------|------------|-----|------------|-----|----------|------------------|-----|------------------|-----|---------|-----------|
| | | BACK PROJ. | | BACK PROJ. | | | DANCE FLOOR | | DANCE FLOOR | | | |
| Léman A | 18 | 400 | 530 | 220 | 320 | 800 | 350 | 450 | 270 ² | 370 | – | – |
| Léman B | 18 | 110 | 250 | 60 | 170 | 400 | 140 | 210 | – | 160 | – | – |
| Léman A+B | 19 | 720 | 900 | 400 | 550 | 1200 | 590 | 690 | 420 | 520 | – | – |
| Léman C | 19 | – | – | – | – | 250 | – | – | – | – | – | – |
| Pléiades | 17 | 40 | – | 24 | – | 40 | – | 20 | – | – | 17 | 16 |
| Dents-du-Midi | 17 | 60 | – | 35 | – | 40 | – | 40 | – | – | 24 | 22 |
| Rochers-de-Naye | 17 | 48 | – | 24 | – | 40 | – | 30 | – | – | 20 | 18 |
| Salle des Congrès | 10 | 250 | 350 | 150 | 240 | 600 | 280 | 340 | 200 | 260 | – | – |
| Salle des Fêtes | 12 | 210 | | 120 | | 400 | 150 ³ | 180 | 100 ³ | 120 | 60 | 50 |
| Salon Rotary | 11 | 80 | – | 50 | – | 90 | – | 60 | – | 40 | 30 | 28 |
| Salon de Bridge | 13 | 120 | – | 60 | – | 120 | – | 90 | – | 60 | 50 | 50 |
| Salon Club | 14 | 70 | – | 50 | – | 80 | – | 60 | – | 40 | 26 | 22 |
| Salon Vert | 17 | – | – | – | – | – | – | 18 | – | – | – | 18 |
| Salon Rouge | 15 | 20 | – | 10 | – | – | – | – | – | – | – | 15 |
| Lobby | 7 | – | – | – | – | 300 | – | – | – | – | – | – |
| La Coupole | 21 | – | – | – | – | 300 | – | 130 | – | – | – | – |
| La Terrasse du Petit Palais | 20 | – | – | – | – | 800 | – | 400 | – | – | – | – |

Using the existing stage

²A buffet can be set up in Léman C

³A buffet can be set up in Le Salon de Bridge

DIMENSIONS

| ROOM NAME | PAGE NO. | OVERALL DIMENSIONS | | SQUARE | | HEIGHT | |
|-----------------------------|----------|--------------------|-------------|--------|--------|---------|-------------|
| | | FEET | METERS | FEET | METERS | FEET | METERS |
| Léman A | 18 | 92' x 62' | 28 x 19 | 5704 | 532 | 19' | 5.65 |
| Léman B | 18 | 46' x 62' | 14 x 19 | 2852 | 266 | 19' | 5.65 |
| Léman A+B | 19 | 138' x 62' | 42 x 19 | 8556 | 798 | 19' | 5.65 |
| Léman C | 19 | 72' x 43' | 22 x 13 | 3096 | 286 | 8'–19' | 2.55 – 5.65 |
| Pléiades | 17 | 25' x 19' | 7.7 x 5.7 | 475 | 44 | 10' | 3 |
| Dents-du-Midi | 17 | 32' x 20' | 9.7 x 6.2 | 640 | 60 | 8' | 2.52 |
| Rochers-de-Naye | 17 | 28' x 28' | 8.45 x 8.6 | 784 | 73 | 9' | 2.65 |
| Salle des Congrès | 10 | 107' x 38' | 32.5 x 11.5 | 4066 | 374 | 16'–29' | 5 – 9 |
| Salle des Fêtes | 12 | 69' x 36' | 21 x 11 | 2484 | 231 | 16'–29' | 5 – 9 |
| Salon Rotary | 11 | 38' x 28' | 11.5 x 8.5 | 1064 | 98 | 26' | 8 |
| Salon de Bridge | 13 | 72' x 20' | 22 x 6 | 1440 | 132 | 10'–20' | 3 – 6 |
| Salon Club | 14 | 35' x 29' | 10.6 x 9 | 1015 | 95 | 11'–20' | 3.5 – 6 |
| Salon Vert | 17 | 33' x 20' | 10 x 6 | 660 | 60 | 8'–13' | 2.5 – 4 |
| Salon Rouge | 15 | 33' x 20' | 10 x 6 | 660 | 60 | 20' | 6 |
| Lobby | 7 | 44' x 67' | 13.4 x 20.4 | 2948 | 273 | 26' | 8 |
| La Coupole | 21 | 62' x 41' | 19 x 12.6 | 2542 | 240 | 12' | 3.55 |
| La Terrasse du Petit Palais | 20 | 44' x 143' | 13.5 x 43.7 | 6292 | 590 | 12' | 3.55 |

Covered parking facilities for up to 175 cars

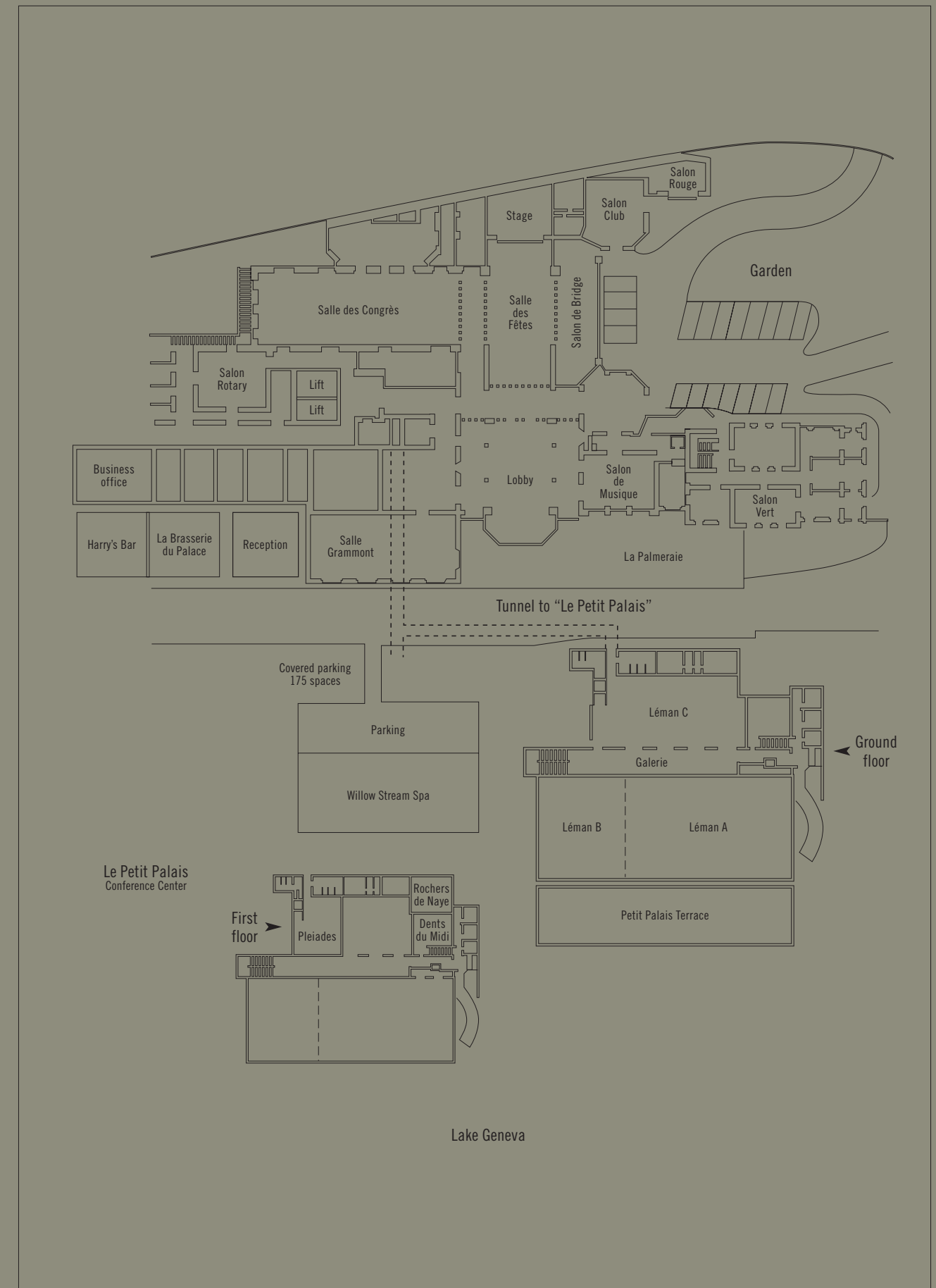

GLOBAL SALES OFFICES

| LOCATION | TEL | FAX | E-MAIL |
|---------------------------|-------------------|-------------------|--------------------------------------|
| North America | | | |
| Atlanta | +1 662 280 7757 | +1 662 280 7758 | atlantaglobalsales@fairmont.com |
| Chicago | +1 773 509 1762 | +1 773 509 1782 | chicagoglobalsales@fairmont.com |
| Dallas | +1 972 401 1155 | +1 972 401 9137 | dallasglobalsales@fairmont.com |
| Los Angeles | +1 323 656 1664 | +1 323 656 1639 | losangelesglobalsales@fairmont.com |
| Mexico | +55 5256 3515 | +55 5256 3515 | mexicoglobalsales@fairmont.com |
| New Jersey | +1 856 988 7960 | +1 856 988 7961 | newjerseyglobalsales@fairmont.com |
| New York | +1 212 715 7000 | +1 212 750 0570 | newyorkglobalsales@fairmont.com |
| Ottawa | +1 613 562 7018 | +1 613 562 7058 | ottawaglobalsales@fairmont.com |
| San Francisco | +1 415 383 2070 | +1 415 383 2072 | sanfranciscoglobalsales@fairmont.com |
| Toronto | +1 416 874 2600 | +1 416 874 2431 | torontoglobalsales@fairmont.com |
| Vancouver | +1 604 669 2700 | +1 604 669 3607 | vancouverglobalsales@fairmont.com |
| Washington | +1 888 560 5066 | +1 888 278 3688 | washingtonglobalsales@fairmont.com |
| Europe/Middle East | | | |
| Frankfurt | +49 6172 171834 | +49 6172 171836 | frankfurtglobalsales@fairmont.com |
| Jeddah | +966 2 614 0456 | +966 2 614 0456 | saudiariabglobalsales@fairmont.com |
| London | +44 845 071 0170 | +44 845 071 0171 | londonglobalsales@fairmont.com |
| Milan | +39 338 265 3287 | +39 039 470337 | milanglobalsales@fairmont.com |
| Moscow | +7 495 510 5710 | +7 495 790 7371 | moscowglobalsales@fairmont.com |
| Paris | +33 1 45 60 05 47 | +33 1 45 60 40 16 | parisglobalsales@fairmont.com |
| Asia Pacific | | | |
| Hong Kong | +852 254 23399 | +852 285 04797 | hongkongglobalsales@fairmont.com |
| Shanghai | +86 21 6340 3200 | +86 21 6340 3233 | shanghaiglobalsales@fairmont.com |
| Singapore | +65 6339 8377 | +65 6339 1713 | singaporeglobalsales@fairmont.com |
| Sydney | +61 2 9238 8843 | +61 2 9238 8831 | sydneyglobalsales@fairmont.com |
| Tokyo | +81 3 3211 8059 | +81 3 3211 8029 | tokyoglobalsales@fairmont.com |

For meetings and events, please contact your Global Sales Representative, call 1 866 662 6060 (North America) or +1 506 877 3162 (international), or e-mail GlobalEventsandMeetingsSolutions@fairmont.com

Fairmont
LE MONTREUX PALACE
MONTREUX, SWITZERLAND

Grand Rue 100
1820 Montreux
Switzerland
TEL +41 21 962 1212
FAX +41 21 962 1717
E-MAIL montreux@fairmont.com
www.fairmont.com/montreux
www.montreux-palace.ch



Fairmont Hotels & Resorts has been a WWF Climate Savers partner since 2009 and has committed to reducing its emissions by 20% below 2006 levels by 2013.